



Electrolux

Upright Vacuum Cleaner

Owner's Guide

Household Type

Z8800 Series

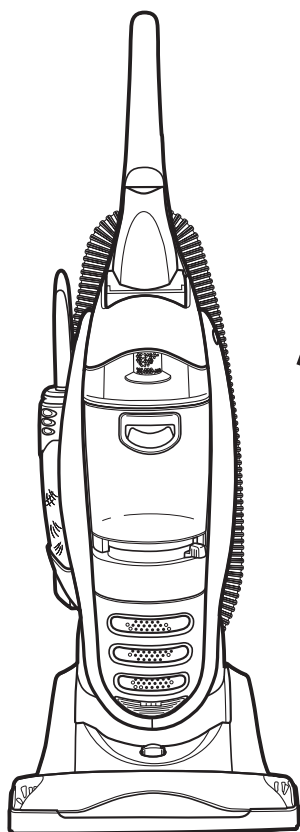

THE POWER OF
RED

IMPORTANT

For any advice
on your cleaner and
to order filters and
accessories,
please telephone the
Electrolux Helpline on
08706 055055

2 – 4 **IMPORTANT INFORMATION**

4 **GUARANTEE**

5 **QUICK REFERENCE**

5 **HOW TO ASSEMBLE**

7 **HOW TO USE**

10 **ROUTINE MAINTENANCE**

10 **Dust Cup**

11 **Top Filter**

11 **Bottom Filter**

12 **Clear Blockages/Hose**

13 **Brushroll**

13 **Brushroll Belt**

14 **PROBLEM SOLVING**



The Electrolux Group

FILTER REPLACEMENT CODE: EF105 and EF106

www.electrolux.co.uk

IMPORTANT SAFEGUARDS

When using an electrical appliance, basic precautions should always be followed, including the following:

READ ALL INSTRUCTIONS BEFORE USING THIS VACUUM CLEANER.

WARNING

To reduce the risk of fire, electric shock, or injury:

- Do not use outdoors or on wet surfaces.
- **Do not leave vacuum cleaner when plugged in.** Turn off the switch and unplug the electrical cord when not in use and before servicing.
- This appliance is not intended for use by any persons (including children) with reduced physical, sensory or mental capabilities, or lack of experience and knowledge, unless they have been given supervision or instruction concerning use of the appliance by a person responsible for their safety.
- Children should be supervised to ensure that they do not play with the appliance.
- Use only as described in this manual. Use only manufacturer's recommended attachments.
- Do not use with damaged cord or plug. If vacuum cleaner is not working as it should, has been dropped, damaged, left outdoors, or dropped into water, return it to a service centre before using.
- Do not pull or carry by cord, use cord as a handle, close a door on cord, or pull cord around sharp edges or corners.
- Do not run vacuum cleaner over cord. Keep cord away from heated surfaces.
- Do not use extension cords or outlets with inadequate current carrying capacity.
- Turn off all controls before unplugging.
- Do not unplug by pulling on cord. To unplug, grasp the plug, not the cord.
- Do not handle plug or vacuum cleaner with wet hands.
- Do not put any object into openings. Do not use with any opening blocked; keep free of dust, lint, hair, and anything that may reduce air flow.
- This vacuum cleaner creates suction and contains a revolving brushroll. Keep hair, loose clothing, fingers, and all parts of body away from openings and moving parts.
- Do not place cleaner on furniture or stairs as the brushroll may cause damage. Place cleaner on floor with the handle in storage position while using attachments.
- Do not pick up anything that is burning or smoking, such as cigarettes, matches, or hot ashes.
- Do not use without the dust cup or filter(s) in place.
- Belt pulleys can become hot during normal use. To prevent burns, avoid touching the belt pulley when servicing the drive belt.
- Use extra care when cleaning on stairs.
- Do not use to pick up flammable or combustible liquids such as gasoline, or use in areas where they may be present.
- Store your cleaner indoors in a cool, dry area.
- Keep your work area well lighted.
- Unplug electrical appliances before vacuuming them.

PLEASE SAVE THESE INSTRUCTIONS

WARNING

The brush in the cleaning head rotates at high speed and can cause damage to the mains supply cable if the cleaner passes over it during cleaning operations.

Care should be taken to ensure that this does not happen. If the cleaning head has accidentally passed over the mains supply cable the following action should be taken:

1. Switch off and remove the plug from the socket outlet.
2. Examine the mains supply cable for damage (only after removing the plug from the socket outlet).
3. If there is any sign of damage to the supply cable it **MUST** be renewed. The repair **MUST** be carried out by an Electrolux Service Agent or a similar qualified person.
4. **NEVER** use the machine with a damaged mains supply cable.

Proprietary carpet conditioning and air freshening materials

After using proprietary carpet conditioning powders, it is recommended that the filters be changed. Some of these preparations contain substances which if left in the vacuum cleaner for extended periods could damage the plastic mouldings which form the structure of the cleaner.

Many air fresheners, household deodorants, sprays and polishes contain a highly flammable gas propellant.

Because of this, it is particularly important that these products are used strictly in accordance with the relevant manufacturer's instructions.

It is essential that none of the above products are sprayed directly into the vacuum cleaner or any of its filters, hose assembly, dustbag chamber or dust cup.

Thermal Cut Off

This vacuum cleaner has a special thermostat that protects the cleaner in case of motor overheating. If the cleaner switches off, push the switch pedal once and unplug the cleaner. Check the cleaner for a possible source of overheating such as a full dust cup, a blocked hose or clogged filter. If these conditions are found, fix them and wait at least 60 minutes before attempting to use the cleaner. After the 60 minute period, plug the cleaner back in and push the on/off switch On (I). If the cleaner still does not run, please call Electrolux Customer Care.

BEFORE YOU START

CHECK THE VOLTAGE

Before connecting the cleaner to an electrical supply, ensure that the voltage shown on the rating plate located beneath the cleaner is of the correct voltage for your electricity supply. If it is not, do not use the cleaner but refer back to your dealer.

CONNECTING TO YOUR ELECTRICITY SUPPLY

Permanently connected to the cleaner is a mains supply (2-core) cable fitted with a non-rewirable plug incorporating a 13A fuse.

In the event of the fuse requiring replacement the fuse cover should be removed using a small screwdriver. The old fuse **MUST** be replaced by a 13A ASTA approved BS1362 fuse or a BSI approved fuse. The cover must be replaced before the plug is used again. In the event of loss of the fuse cover, replacements can be obtained from your Electrolux Retailers and must be of the same colour as indicated by the coloured insert on the base of the plug.

If difficulty is experienced in obtaining a replacement, contact Electrolux Customer Services on 08706 055055.

In no circumstances must the plug be used without a correct fuse cover fitted.

If the plug that is fitted to your appliance is not suitable for your socket outlet, it must be cut off and the appropriate plug fitted.

Remove the fuse from the cut off plug.

The cut off plug should then be disposed of to prevent the hazard of shocks in case it should be plugged into a 13 amp socket in another part of your home.

The wires in the mains cable of this appliance are coloured in accordance with the following code: Blue: Neutral. Brown: Live.

As the colours of the wires in the mains cable of this appliance may not correspond with the coloured markings identifying the terminals in your plug, proceed as follows:

The wire which is coloured blue must be connected to the terminal which is marked with the letter N or coloured black.

The wire which is coloured brown must be connected to the terminal which is marked with the letter L or coloured red.

If using a three-pin plug, do not make any connection to the terminal marked with the letter E or by the earth symbol or coloured green or green-and-yellow. This cleaner is double insulated and no earth connection is necessary.

It is in your interest to ensure that the plug is correctly attached to the mains cable. In case of doubt, consult a qualified electrician, as Electrolux cannot regard the repair of faults on the plug connection as a service that can be given free of charge under the terms of the guarantee.

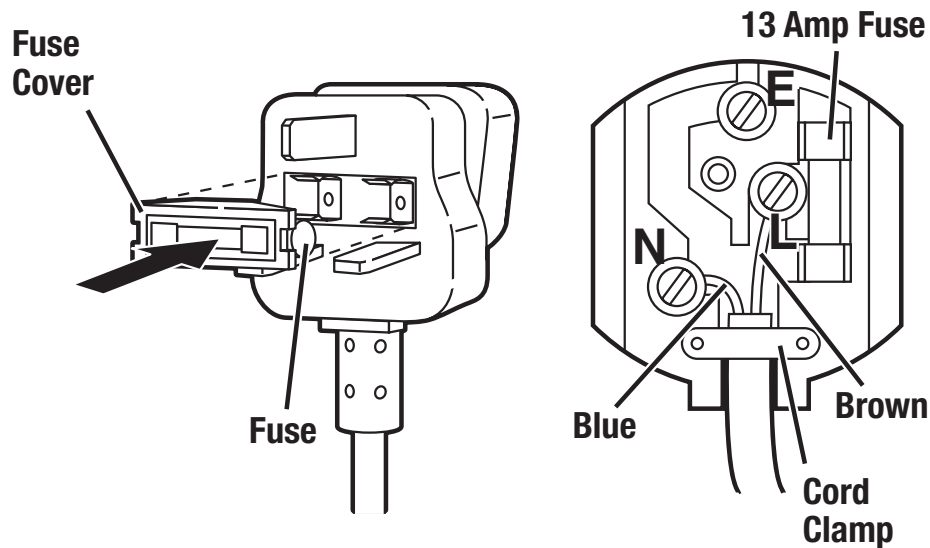

The symbol  on the product or on its packaging indicates that this product may not be treated as household waste. Instead it shall be handed over to the applicable collection point for the recycling of electrical and electronic equipment. By ensuring this product is disposed of correctly, you will help prevent potential negative consequences for the environment and human health, which could otherwise be caused by inappropriate waste handling of this product. For more detailed information about recycling of this product, please contact your local city office, your household waste disposal service or the shop where you purchased the product

SERVICE

Should you require service on your Electrolux cleaner, please telephone Electrolux Customer Services on 08706 055055. Before requesting service, please check whether your problem is covered under Service Checklist (see below).

New filter pads, brushrolls and drive belts can be obtained from Electrolux Retailers. If difficulty is experienced in obtaining spares, please contact Electrolux on 08706 055055.

SERVICE CHECKLIST

- If your cleaner will not operate, check the plug connection, plug fuse and mains fuse.
- Never allow the dust cup to become so full that it impedes the air flow, thus reducing the cleaning efficiency of the machine. The character of household dust and its effect on the air flow through the machine may vary considerably. Fluffy dust allows air to pass through readily whereas fine powdery dust or proprietary cleaning powders, pack tightly in the dust cup, offering greater resistance to air flow and will reduce cleaning efficiency if the cup becomes overloaded.
- Always store your cleaner and spare dust filters in a dry place.
- Renew the filter pads three or four times a year. This is essential to ensure continued high filtration of dust particles.
- Sucking up such items as stockings, clippings of cloth, sizeable pieces of paper, wrappings from cigarette packets or sweets etc., may block the hose. Electrolux regrets that the clearing of blocked hoses cannot be regarded as service that can be given free of charge, under the guarantee. Should a blockage occur, first disconnect the cleaner from the electricity supply, refer to section headed "Blockages". If these operations are not successful, contact Electrolux on 08706 055055.
- Never pick up hot cinders or lighted cigarette ends.
- **Make certain that your cleaner does not come into contact with water or any other liquid. It is not designed as a wet pick up cleaner, and must never be used on damp carpets or wet floors.**

Important - in the event of the mains supply cable of this vacuum cleaner requiring replacement, we recommend that this be carried out by Electrolux Service Staff.

Spares

New filters, brushrollers and drive belts can be obtained from Authorised Electrolux Dealers and electrical retailers. If difficulty is experienced in obtaining spares please call us on 08706 055055 or visit our website at www.shop.electrolux.co.uk

GUARANTEE

This guarantee is in addition to your statutory and other legal rights.

This product is for household use only.

Electrolux products are carefully designed, manufactured, tested and inspected and, in consequence, we undertake to replace or repair any part found to be defective in materials or workmanship, within one year of delivery to the original purchaser, free of charge. You may be required to take the product to your nearest service provider if the product requires attention during the first year.

There are certain conditions which may invalidate this guarantee:

- a. It is dependent upon the appliance being correctly installed and used in accordance with the Company's instructions under normal domestic conditions within the United Kingdom or the Republic of Ireland.
- b. Service at all times must be carried out by an Electrolux Service Representative or authorised agent.
- c. The guarantee may be invalidated by unauthorised repair or modification of the appliance.
- d. You may be charged by Electrolux if you call for an engineer to resolve a problem that we believe is covered in the instruction booklet. (example: blocked/dirty filters)

Electrolux does not accept liability for all defects arising from neglect, misuse or accident. This guarantee excludes such normal wearing parts as drive belts, brushes and filters as the life of these depends upon the amount and nature of use.

Proof of purchase will be required before service under guarantee is provided. Please call 08706 055 055 for assistance.

IMPORTANT:

For future reference we suggest you record the following details here, and keep the receipt with the handbook as proof of purchase.

Purchased from _____

Date purchased _____ Model no _____



101 Oakley Road, LUTON, BEDFORDSHIRE, LU4 9QQ

Features of the Electrolux vacuum cleaner and accessories supplied with it are protected in Great Britain and abroad by Patents or Registered Designs.

This appliance conforms with the requirements of the amended E.E.C. directive No. 89/336/EEC relating to electromagnetic compatibility (EMC) CE.

Electrolux, may introduce modifications to their product from time to time, and consequently the details given in this booklet are subject to alteration without notice.

HOW TO IDENTIFY PARTS OF CLEANER

Items in Carton

- cleaner body
- handle
- hose clip
- screws (4 in bag)
- dusting brush
- combination crevice tool & nested wand
- turbo nozzle (on some models)

- 1) Hose
- 2) Turbo nozzle
- 3) Filter screen
- 4) Self cleaning duster (on some models)
- 5) Duster activation knob
- 6) Cleaner height setting
- 7) Edge cleaner windows
- 8) On/Off switch
- 9) Dust cup
- 10) Dust cup release
- 11) HEPA filter compartment
- 12) Dusting brush
- 13) Hose support
- 14) Tool caddy, carry handle & upper cord wrap
- 15) Hose wand
- 16) Power supply cord
- 17) Nested crevice tool & extension wand
- 18) Quick release (lower) cord wrap
- 19) Handle release

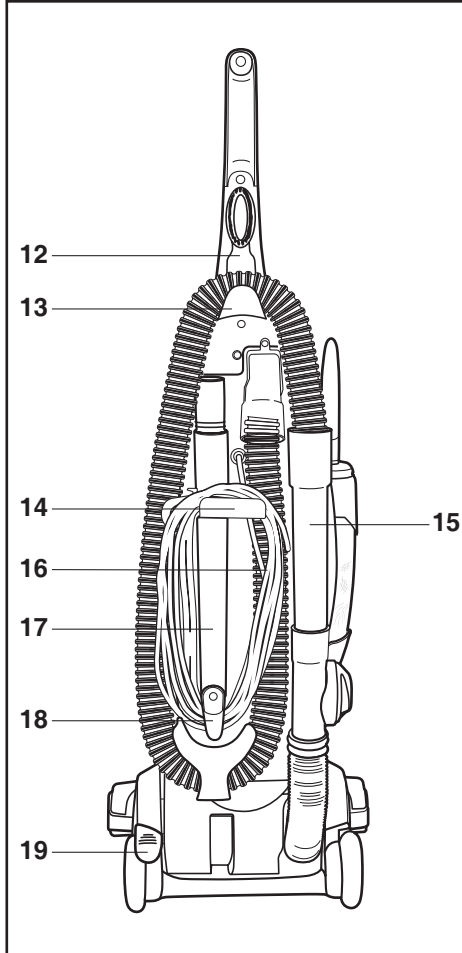
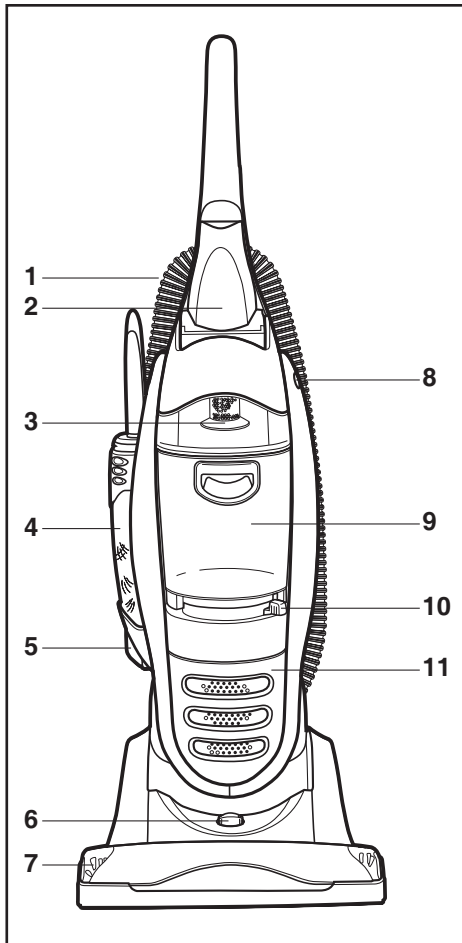

HOW TO ASSEMBLE

Caution: Assemble the cleaner before using.

Caution: Moving parts. Make sure On/Off switch is in OFF (o) position before plugging in.

Step 1:

Slide the handle into place from the back of the cleaner (as shown), aligning the curved edges of the handle with the main body.

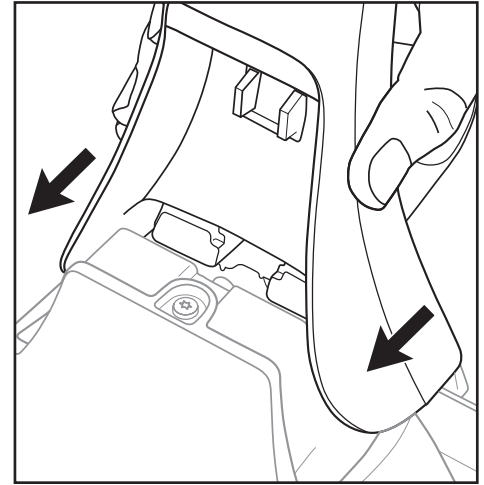

Step 2:

Fasten handle with 2 screws.

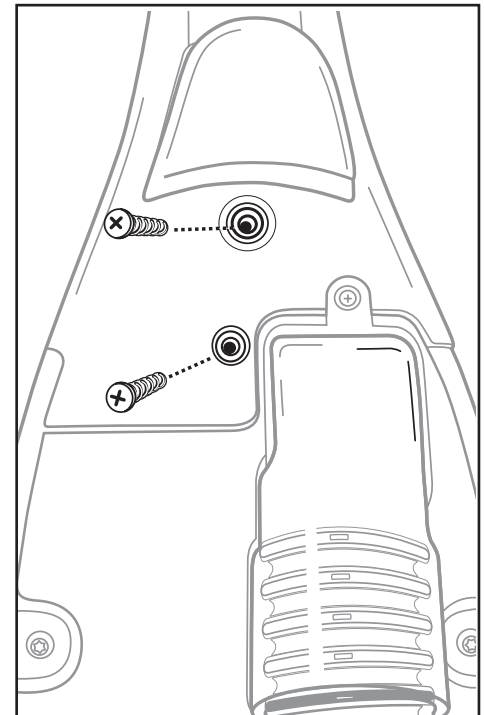

HOW TO ASSEMBLE cont.

Step 3:

Move the hose out of the way before the next step (Step 4) as shown.

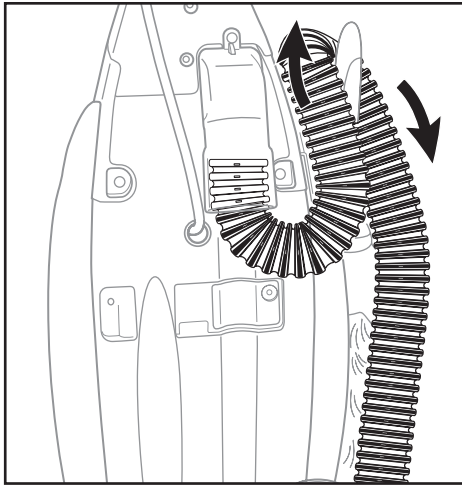

Step 4:

Attach the tool caddy by inserting the tab as shown, and rotating it forward.

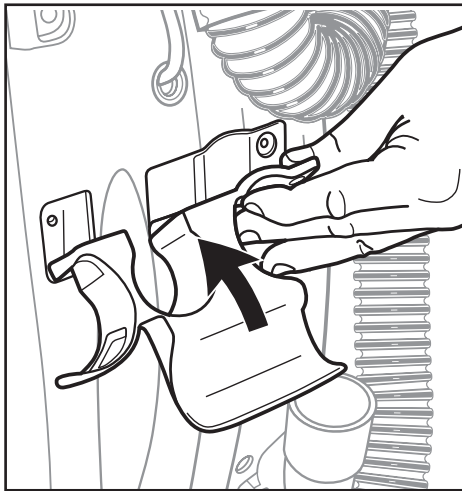

Step 5:

Fasten the tool caddy with 2 screws. The left screw will need to be fastened as shown (through the hole in the tool caddy's hose guide).

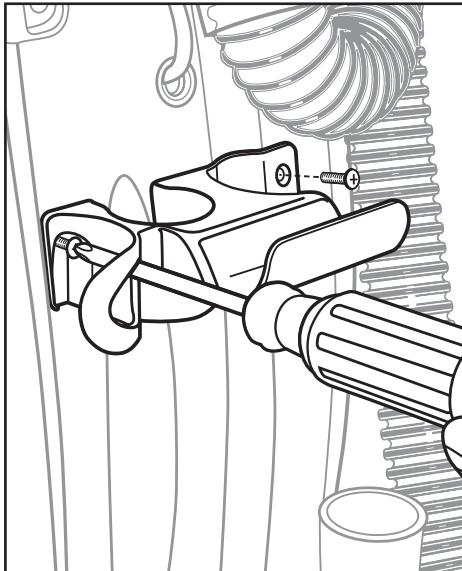

HOW TO ASSEMBLE cont.

Step 6:

Wrap the cord around the upper and lower (quick release) cord wrap as shown.

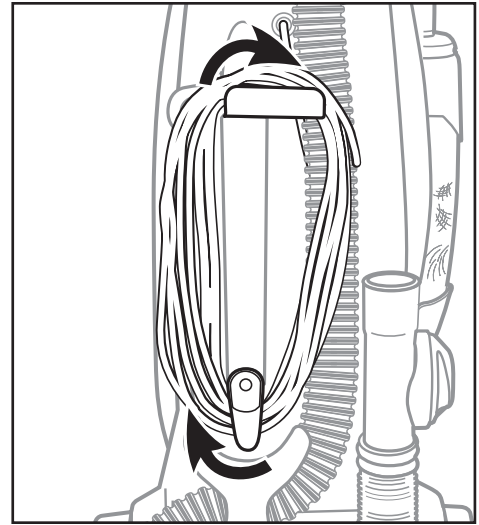

Step 7:

Store the hose as shown, following the arrow, and secure into place.

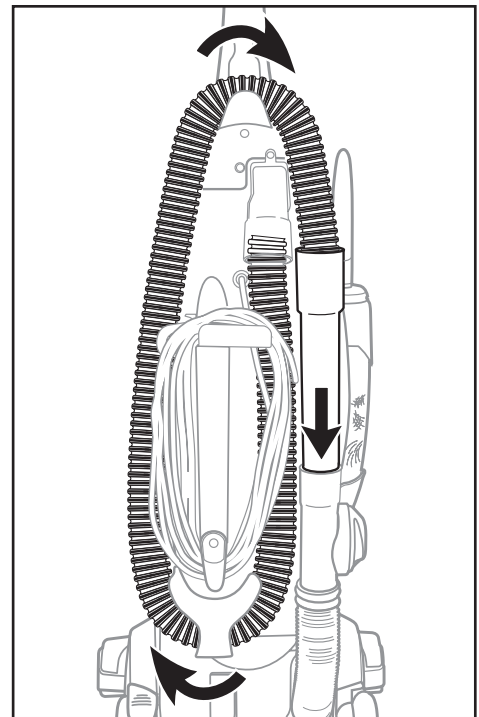

Step 8:

Store the combination crevice tool and extension wand in the tool caddy as shown.

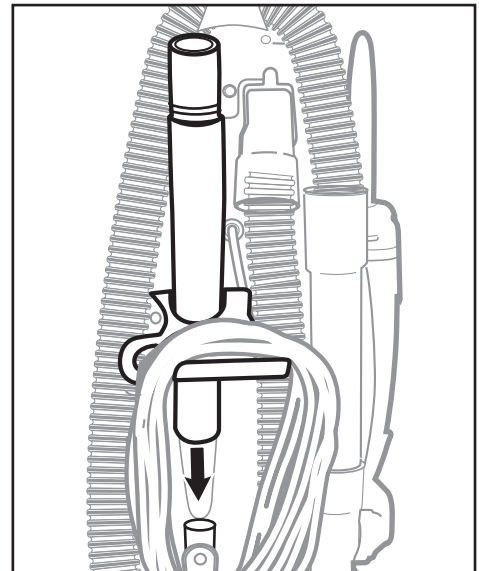

HOW TO ASSEMBLE cont.

Step 9:

Store the dusting brush behind the handle as shown.

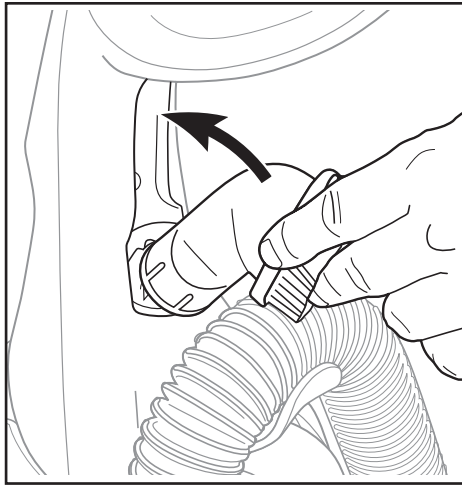

Step 10:

Store the turbo nozzle on the front of the cleaner, above the dust cup, as shown. Push to lock in place.

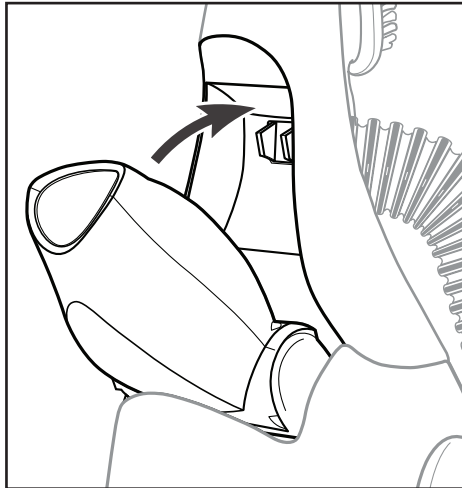

Helpful Hints: Use caution when using this vacuum on area rugs. Do not use the vacuum on or near the fringe of area rugs, as it may damage your rug.

HOW TO USE THE CLEANER

1) Use the carrying handle to carry unit from place to place.

2) To release power cord, twist lower cord hook up.

3) On/off switch, International symbol (I) means On, international symbol (O) means Off.

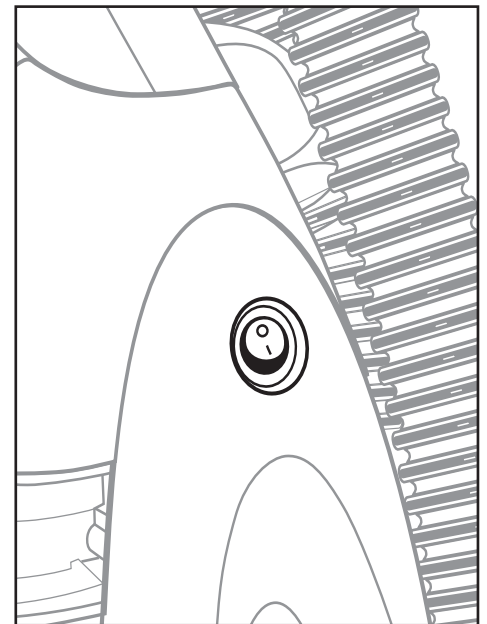
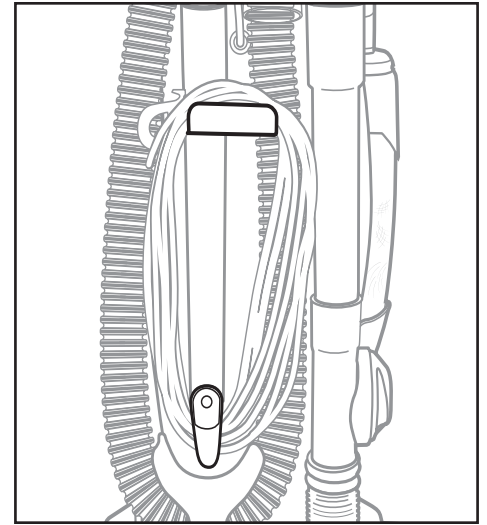

HOW TO USE CLEANER cont.

Warning: to avoid injury, keep loose clothing, fingers, hair, etc. away from moving brushroll.

4) Set Cleaner Height Setting from High setting for long pile to Low for short pile.

Note: If cleaner is hard to push, move selector to next highest setting. Brushroll must reach carpet for best cleaning results.

5) To clean hard floors, set the Cleaner Height Setting to "hard floor"

6) Step on the handle release. Pull handle back to a comfortable position. To lay handle all the way down step on handle release again.

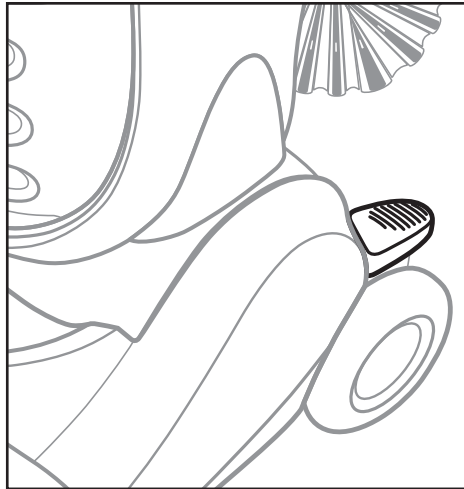
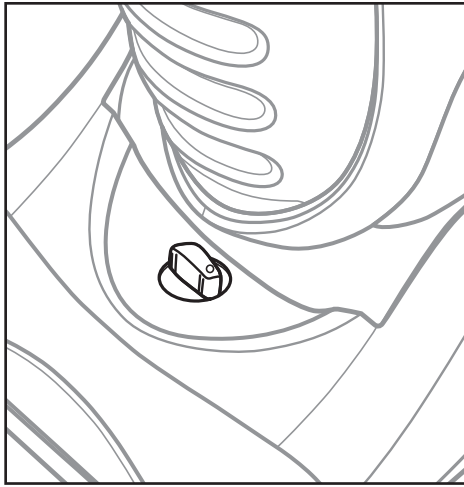

HOW TO USE ACCESSORIES

Note: When using accessories, cleaner handle must be in upright position.

- 1) Remove hose from rear of cleaner.
- 2) Place desired accessory onto end of hose or wand.
- 3) Dusting brush is for furniture, blinds, books, lamp shades, shelves. Crevice tool cleans corners, baseboards, between cushions.

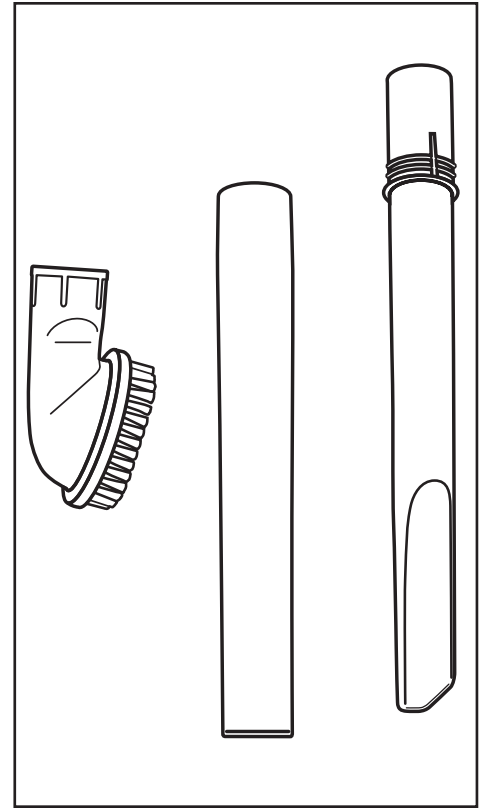

Combination crevice tool & nested wand.

- 1) Grasp crevice tool near ridges.
- 2) Pull apart.
- 3) Turn ridge end to center.
- 4) Push crevice tool into the wand.

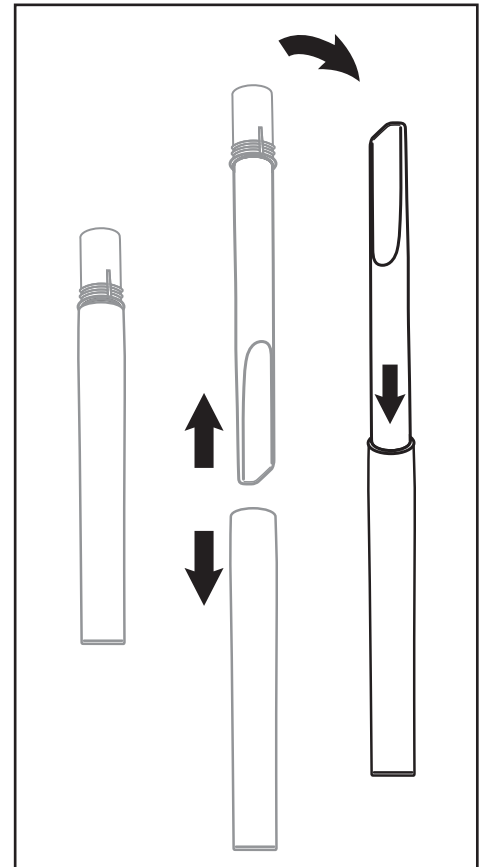

HOW TO USE ACCESSORIES cont.

Warning: To reduce the risk of injury from a falling cleaner, always work with the cleaner below you, pushed against the bottom step.

Caution: Do not place the cleaner on the stairs as this may cause carpet damage.

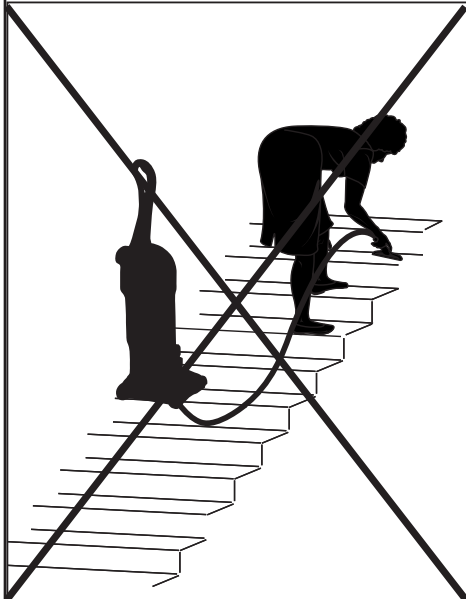
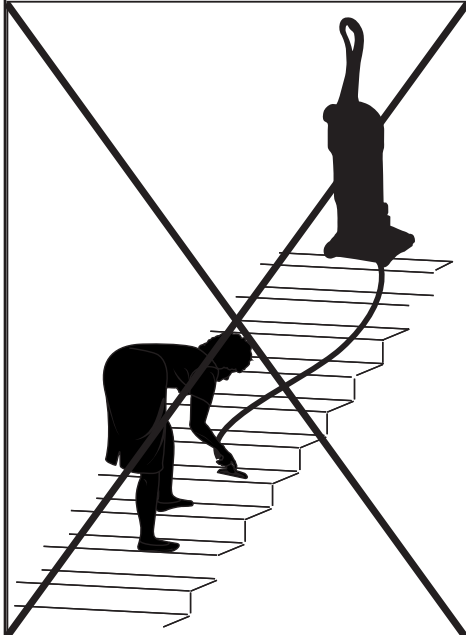
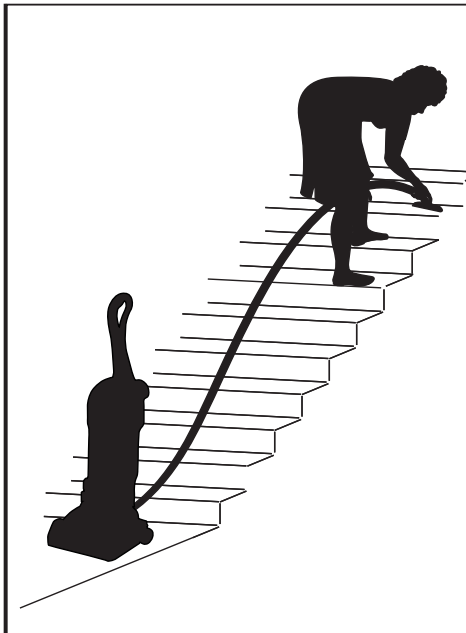

HOW TO USE ACCESSORIES cont.

5) **Self Cleaning Duster (on some models)**
- **How To Use:** The self cleaning duster can be used in the short or extended reach positions to dust table tops, book cases, blinds, ceiling fans, etc.

To use the duster, remove it from the duster tube.

To use it in the short position, simply dust the surface(s) you desire.

To use the duster in the extended position, turn the Twist Tabs clockwise and extend the duster; shorten the duster when you are done, and lock it by aligning the short pegs with the arrow and turn the Twist tabs counter-clockwise.

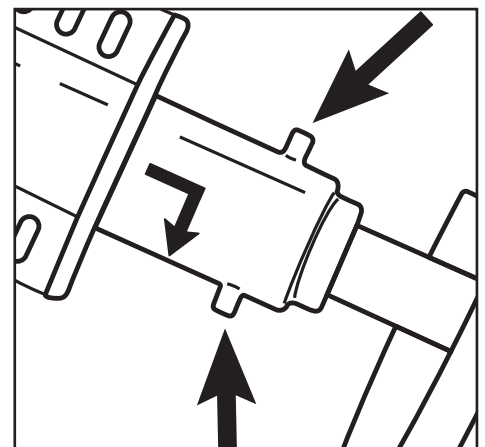
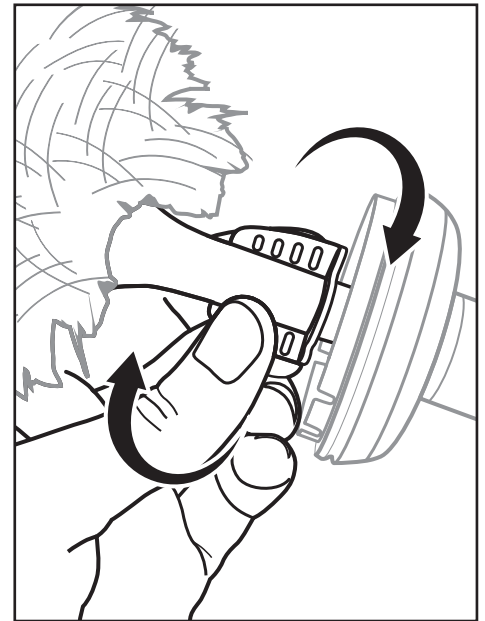
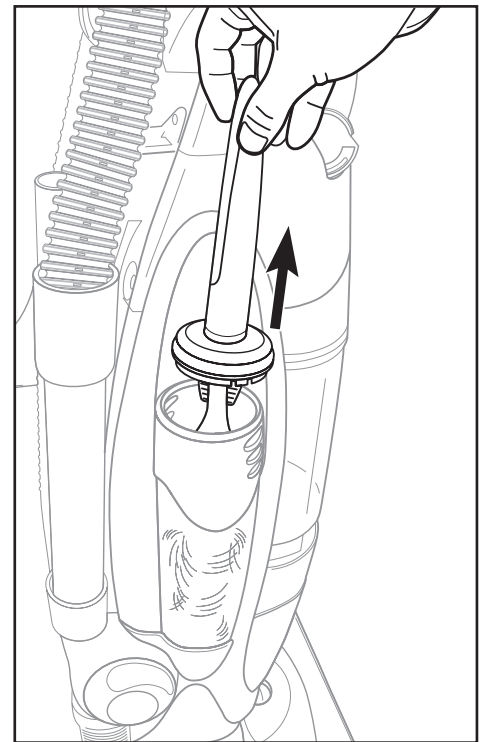

HOW TO USE ACCESSORIES cont.

6) Self Cleaning Duster (on some models)

- How To Clean:

Secure the duster into the Duster Tube, and rotate the Duster Activation Knob counterclockwise (towards the back of the vacuum) to clean the duster.

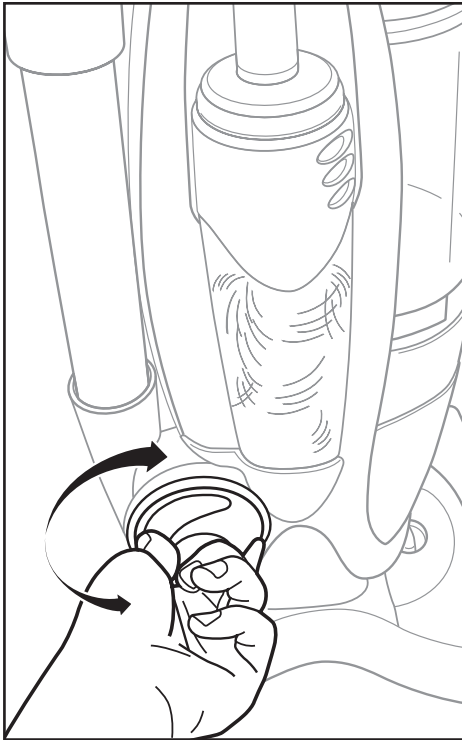

HOW TO MAINTAIN

Important: To avoid unnecessary service calls, check the cyclone, foam & exhaust filters, belt, and brushroll often.

Routine Maintenance

Caution: Turn off the switch and unplug the electrical cord before routine maintenance.

Never operate the vacuum cleaner without the filter screen, top and bottom filters in place.

Note: When vacuuming carpet fresheners or cleaners, powder, plaster dust, or similar fine substances, the top and bottom filters will require more frequent maintenance.

Removing the Dust Cup

- 1) Remove dust cup by sliding dust cup lever from right to left.
- 2) Pull out the dust cup by the dust cup handle.
- 3) Empty dust cup into bin.
- 4) Reposition dust cup in cleaner body and secure by moving lever from left to right.

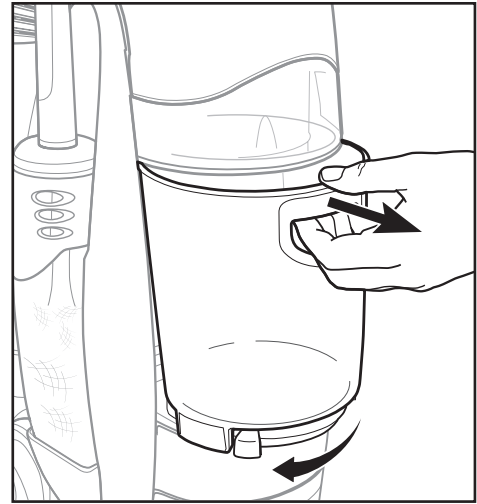

HOW TO MAINTAIN cont.

Caution: Make sure On/Off switch is in Off (o) position and power supply cord is unplugged before servicing.

Clean and Replace Filters * Part Number Foam Filter EF106

Note: The filter screen is located directly above the dust cup.

1) Clean the Filter Screen:

The filter screen is easily removed by turning it counter-clockwise. It should be checked monthly to ensure an open airway. Reinsert the screen by turning it clockwise.

2) Clean the Foam Filter:

The foam filter is located beneath the dustcup and is easily accessed by lifting the access door. It is normal for this filter to collect dirt & debris and should be cleaned regularly depending on vacuuming frequency. Remove the foam filter & frame; remove excess dust foam by shaking or brushing it into a waste basket. The foam filter & filter frame can be hand washed (do not wash in a dishwasher) under warm water. Once the foam filter & filter frame are THOROUGHLY AIR DRIED, place them back into the vacuum before the next use.

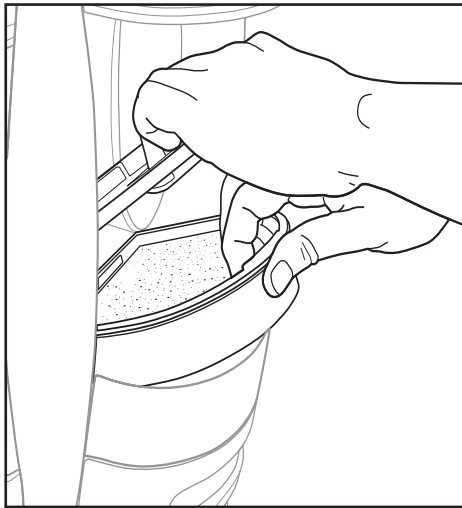

HOW TO MAINTAIN cont.

3) Check the HEPA EF105 Exhaust Filter:

Empty the dust cup and do not place it back in the vacuum; lay the vacuum flat on the floor. The HEPA filter is accessed by removing the foam filter & frame, and turning the knob left. Remove the HEPA filter door completely, and brush off or replace the HEPA filter. Place the HEPA filter into the chamber, lay the filter door in place & turn the knob to the right to secure it. Place the foam filter & frame and the dust cup back in place, and lock the dust cup.

Important: Arm & Hammer deodorizing patches are NOT washable.

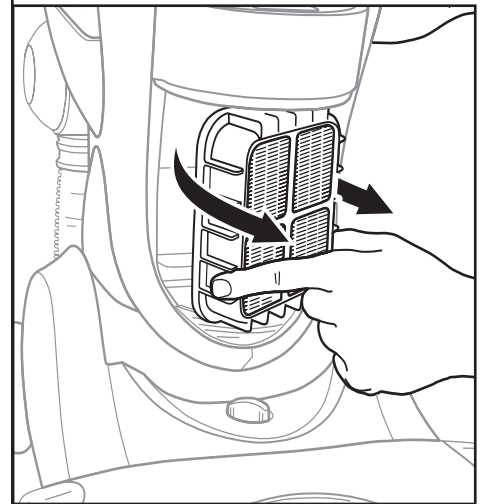
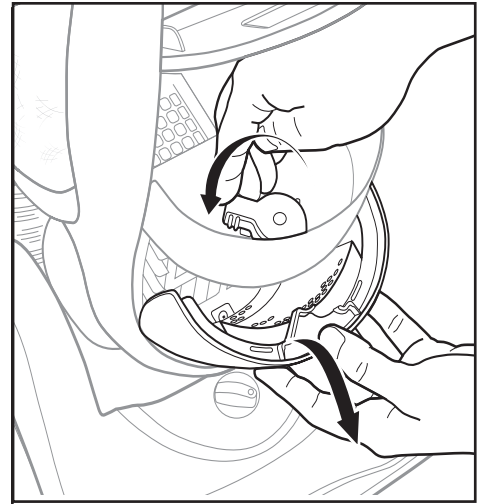

HOW TO MAINTAIN cont.

How to Clear Blockages in Hose

Caution: Make sure On/Off switch is in Off (o) position and power supply cord is unplugged before servicing.

- 1) Firmly pull the end of the hose from the hose retainer on the back of the vacuum.
- 2) Check for blockages in the hose and hose retainer. Flexing the hose may help loosen any blockage. If no blockage is found, continue to step 4. If blockage is found, clear the blockage and replace the hose in the hose retainer. If the blockage is in the hose retainer and cannot be cleared, continue to step 3.
- 3) Remove the hood from the cleaner (see page 24) and check for a blockage in the brushroll area. Make sure the hose inlet is clear. If there is a blockage in the hose inlet, press the handle release to lay the hood flat on the ground. Use a round, dull, long object to push the clog out from the hose inlet. If no blockage is found, continue to step 4. After the blockage is found and cleared, replace the hood on the cleaner.

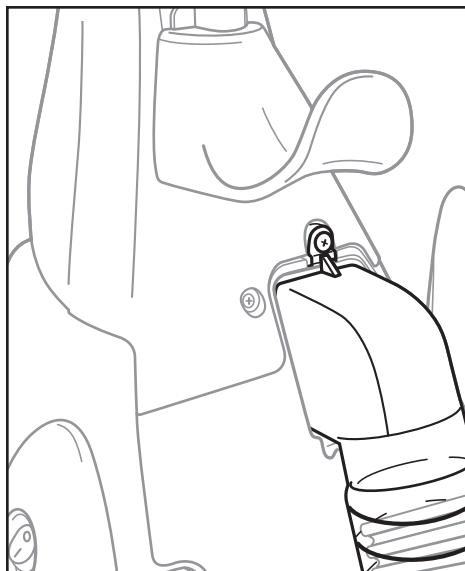

HOW TO MAINTAIN cont.

- 4) Check for blockages at cleaner opening and in hose. If a blockage is found, clear the blockage. The screw attaching the clear hose adapter can be removed for better access to a blockage.
- 5) Screw the hose elbow back onto the back of the cleaner and replace the other end of the hose into the hose retainer.

HOW TO MAINTAIN cont.

Caution: Make sure On/Off switch is in Off (o) position and power supply cord is unplugged before replacing belt. Belt pulley can become hot during normal use. To prevent injury, avoid touching the motor shaft when checking the belt.

Maintain Brushroll

Remove hair and threads from brushroll periodically. For best cleaning bristles must touch carpet, if worn down replace brushroll.

Note: Do not remove endcaps from brushroll.

Maintain Brushroll Belt

*** Part Number ZE096**

Note: Turn off the switch and unplug the electrical cord before replacing belt. Belt pulleys can become hot during normal use. To prevent injury, avoid touching the motor shaft when checking the belt.

- 1) Use foot pedal to lower handle; lay vacuum flat on ground.
- 2) Turn vacuum over
- 3) Remove 4 screws.
Turn vacuum back over (dust cup faces ceiling) and remove the hood of the vacuum.
- 4) Remove brushroll and belt.
- 5) Thread new belt around motor shaft then brushroll.
- 6) Insert left end of brushroll first, then right end.

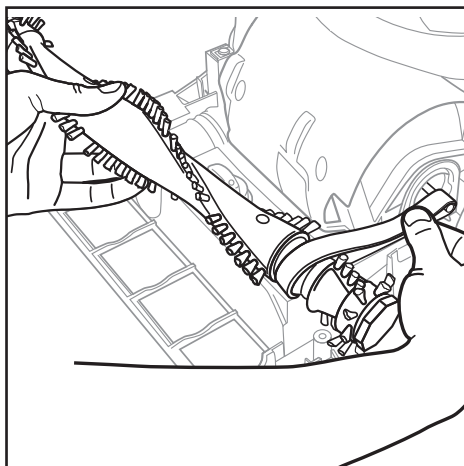
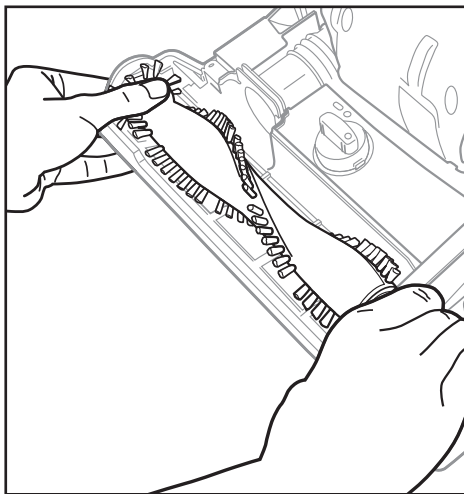
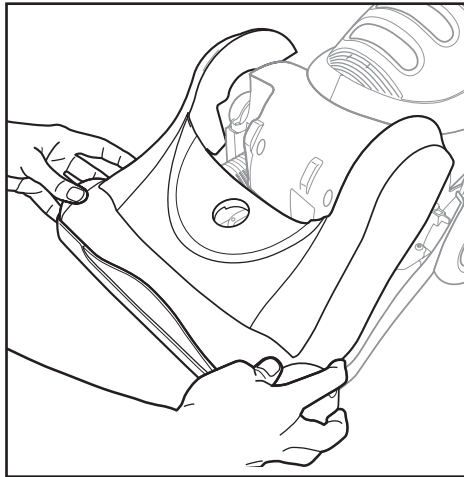
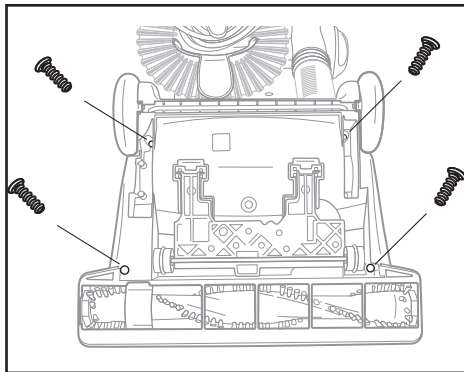

HOW TO MAINTAIN cont.

- 7) Make sure brushroll is completely in compartment. Rotate brushroll 2 turns to center belt.
- 8) Replace hood & turn over (dust cup facing floor). Screw in the 2 screws closest to the brushroll first - this will help align the 2 screws on the rear of the base. Screw in the 2 screws in the rear.

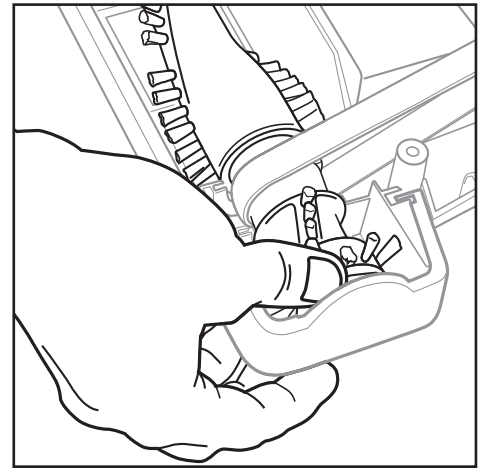

Problem Solving

CAUTION: Turn off the switch and unplug the electrical cord before servicing.

Problem	Cause	Solution
Motor will not start.	Power Plug On/Off Switch Thermal Cut Off	<ul style="list-style-type: none"> • Push plug securely into outlet. • Try another outlet. • Check circuit breaker. • Turn on/off switch to . • Refer to page 2.
Motor suddenly stops.	Thermal Cut Off	<ul style="list-style-type: none"> • Refer to page 2.
Does not clean carpet or hard floor	Dust Cup and Filter(s) Belt Brush Roll Hose Hard Floor Setting Cleaner Height Setting Clear tube blockage	<ul style="list-style-type: none"> • Empty the dust cup and/or change the filters. Hint: If picking up fine dust, the dust cup may not look full, but a fine substance tends to reduce suction when it blocks airflow through the foam filter. Make sure the foam filter is installed properly. • Replace a cut, or out of shape belt. • Clean hair and thread from bristles and end cap area. Replace brush roll if bristles are worn. • Remove any clogs from the hose that restrict the airflow. See pages 12. • For hard floor cleaning, make sure brush roll control is in hard floor position. • For carpet use-make sure proper level is selected, for hardfloor-hardfloor is selected. • See pages 12.
No suction at the end of the hose	Dust Cup and Filter(s) Hose Clear tube blockage	<ul style="list-style-type: none"> • Empty the dust cup and/or change the filters. Hint: If picking up fine dust, the dust cup may not look full, but a fine substance tends to reduce suction when it blocks airflow through the foam filter. Make sure the foam filter is installed properly. • Remove any clogs from the hose that restrict the airflow. See pages 12. • Check hose for cuts or holes. • See pages 12.
Noise from the brush roll area	Brush roll Belt	<ul style="list-style-type: none"> • Remove base plate and clean debris from the brush roll compartment. • Replace a cut or out of shape belt.
Cleaner is hard to push	Cleaner Height Setting Belt	<ul style="list-style-type: none"> • Turn adjustment knob to a higher position. • Replace a cut or out of shape belt.
Brush roll with not turn	Belt	<ul style="list-style-type: none"> • Replace a cut or out of shape belt.
Does not clean carpet or floor	Cleaner height setting	<ul style="list-style-type: none"> • Try alternate height settings.
Handle will not release	Handle release pedal	<ul style="list-style-type: none"> • Step on outer edge of pedal to release.

**If you experience any problems with your cleaner,
don't struggle taking it back to the shop.**

**Call our dedicated Customer Helpline
for help and advice on**

08706 055055

**Thank you for purchasing an Electrolux cleaner.
Don't Forget to Use
Genuine Electrolux Belts and Filters**

Caution: Damages caused by the use of non-genuine
parts are not covered by the Electrolux Guarantee.